

ACCESS PLUG FLANGES

(EPA INSPECTION PORTS)

**MATCH YOUR INSPECTION PORTS
TO YOUR PROCESS TEMPERATURE**

**7 TEMPERATURE
RANGES**

14 STYLES

1200° F

600° F

500° F

350° F

-185° F

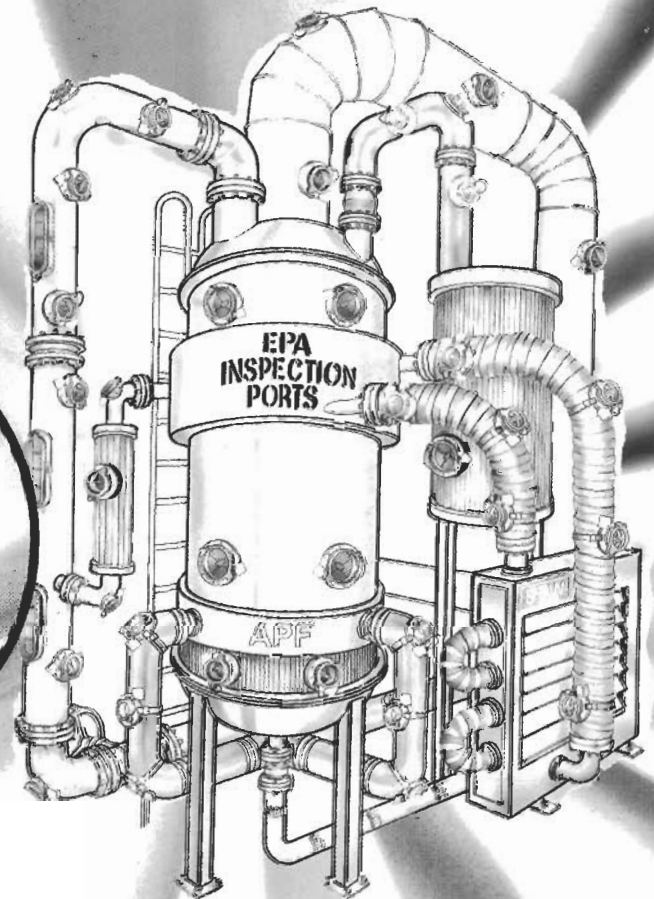
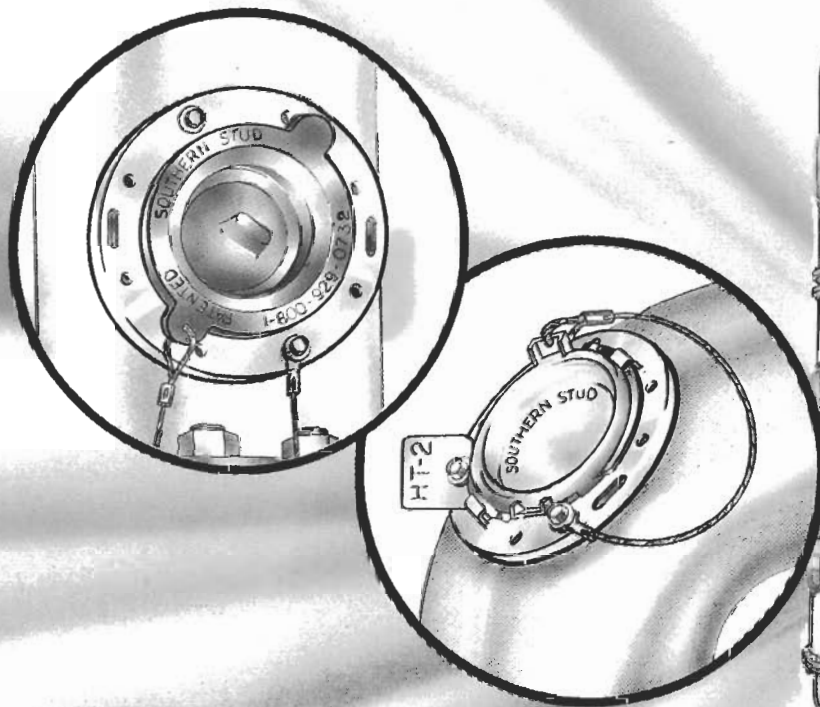

MAKING THINGS WORK

FOR MORE INFORMATION CALL:

SOUTHERN STUD WELD, INC. dba BARTON RESOURCES

HOUSTON, TX. 1-800-929-0296

DALLAS, FORT WORTH, TX. 1-800-929-0732

VISIT OUR WEBSITE @ [HTTP://INSPECTIONPLUG.COM](http://inspectionplug.com)

MADE IN U.S.A.

© BARTON 1998

Southern Stud Weld, Inc. manufactures the most durable and widest range of inspection ports for the oil, gas and petrochemical industry. API 570 defines that class 1, 2 and 3 inspection levels can be identified by separate colors for each. For example, an Access Plug Flange with a blue silicone stopper could represent the class 1, red for class 2, and green for class 3. This system of color-coding will help to eliminate needless inspections and produce an efficient PSM program.

Southern Stud Weld's acquisition of its own elastomers molding facility has been instrumental in the development of matching inspection ports to process temperatures, from extreme hot to cryogenic. The Access Plug Flange ensures the integrity of the system, even if the insulation is lost or discarded during the inspection process. Our Access Plug Flanges are manufactured under patents owned by David D. Barton, President of **Southern Stud Weld, Inc., dba Barton Resources.**

The marketing organization of **Barton Resources** processes sales for **Southern Stud Weld**, and has facilities located in Houston, Texas and in Irving, Texas.

MATCH YOUR INSPECTION PORTS TO YOUR PROCESS TEMPERATURE

SILICONE
RUBBER
PLUG

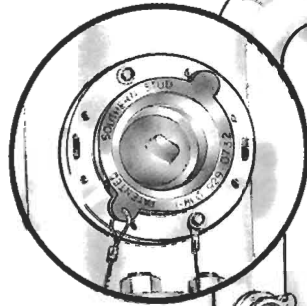

HIGH SILVER
600°F
MED. RED
500°F
LOW BLUE
350°F

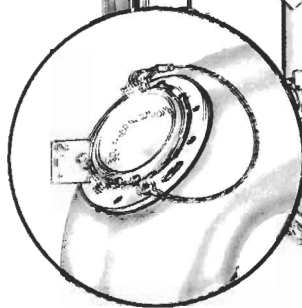

HIGH TEMP
METAL PLUG
HT-2 -
600°F - 1200°F

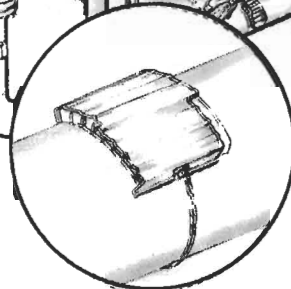

HIGH
TEMP
METAL PLUG
HT-1 -
600°F - 1000°F

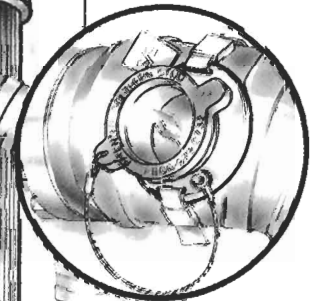

COLD
CHECK
-185°F

EPA
INSPECTION
PORTS

APF

CHECK POINT
STICKER PROTECTION
COVER

ADVANTAGES

NO SPECIAL TOOLS OR HOT WORK PERMITS REQUIRED FOR FIELD INSTALLATIONS. THEREFORE, WORK CREWS AT SEVERAL LOCATIONS CAN BE INSTALLING ACCESS PLUG FLANGES AT THE SAME TIME.

USE ONLY THE AMOUNT OF SCREWS NECESSARY, SILICONE INJECTED UNDER THE FLANGE DOES MOST OF THE WORK. USE INJECTION PORTS/MOUNTING HOLES AS REQUIRED.

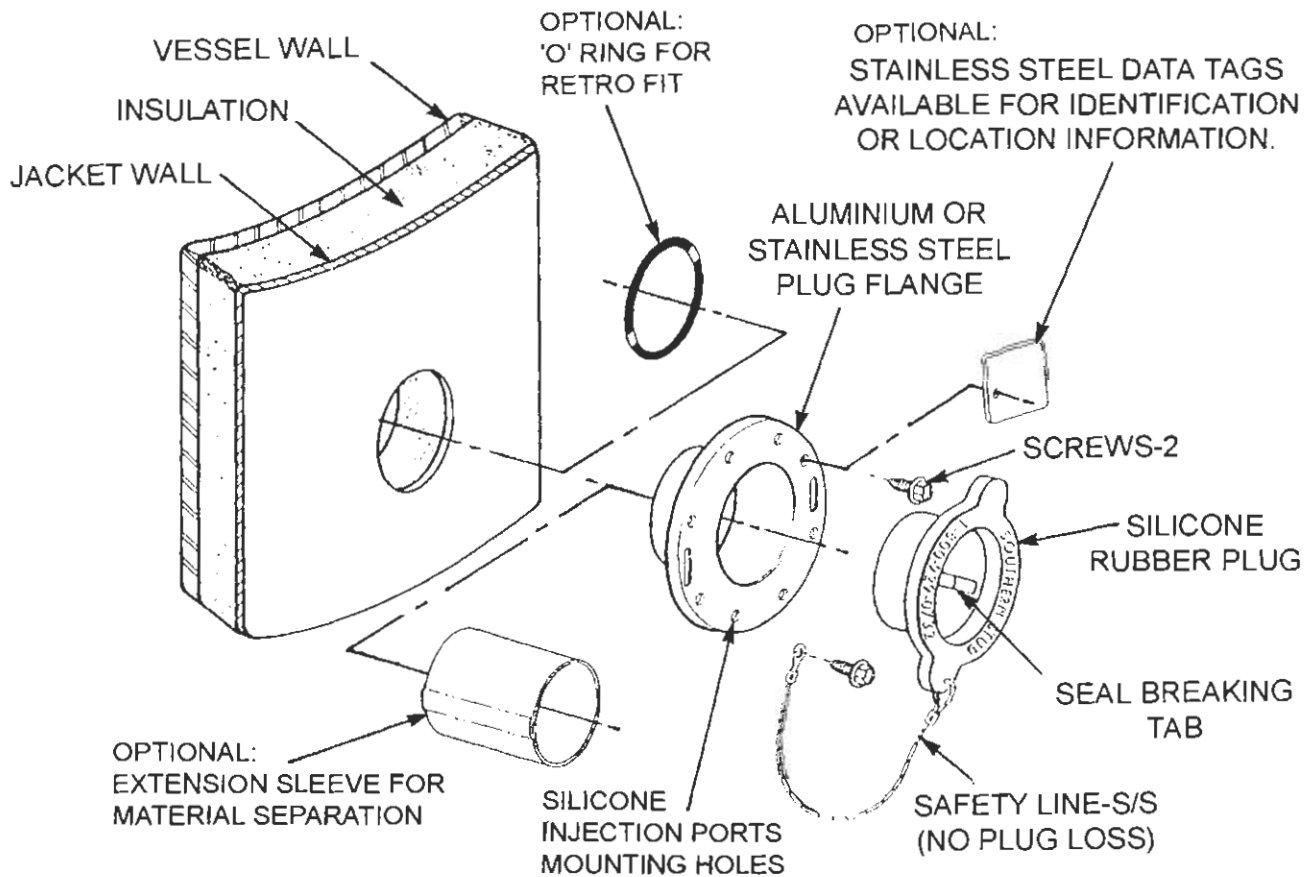

PULL CENTER NIPPLE TO BREAK SEAL



REMOVE RUBBER PLUG AS SHOWN



A UT METER IS USED TO MAKE PROPER INSPECTION

ACCESS PLUG FLANGES

FOR INSULATED PIPE (EPA INSPECTION PORTS)

SILICONE RUBBER PLUG

PROCESS TEMPERATURE RANGES

HIGH SILVER - 600°F

MED. RED - 500°F

LOW BLUE - 350°F

SOUTHERN STUD WELD
INTRODUCES THE FIRST
AND ONLY ACCESS PLUG
FLANGES DESIGNED FOR
THREE DIFFERENT
TEMPERATURE RANGES
OR TO COLOR CODE YOUR
PLANTS TESTING
LOCATIONS

- BANDING SLOT
AVAILABLE FOR VAPOR
BARRIER INSTALLATION

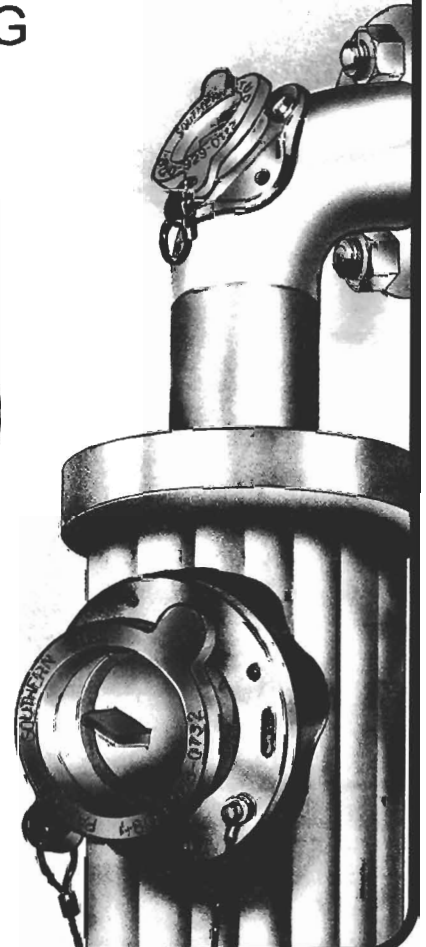
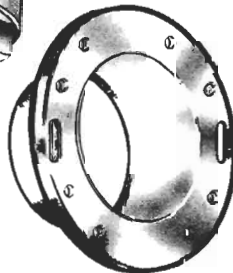
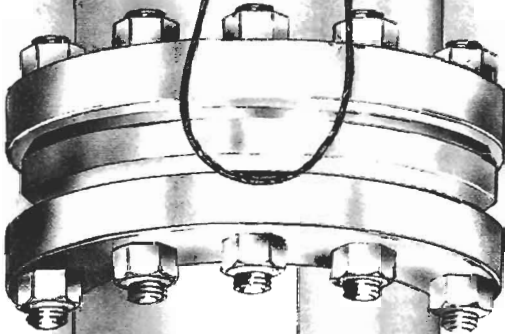
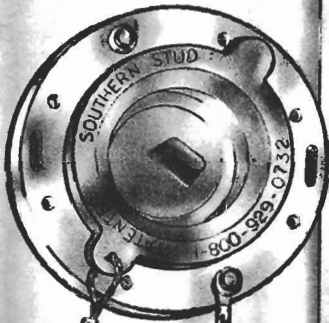
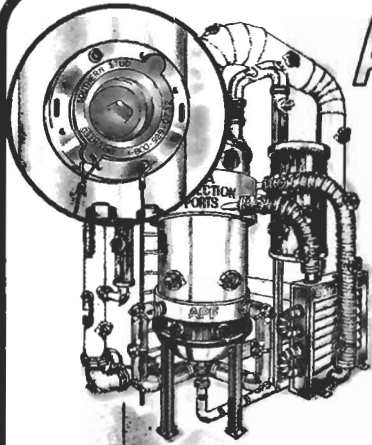

VESSEL WALL
INSULATION
JACKET WALL

4" AND 5"
APF

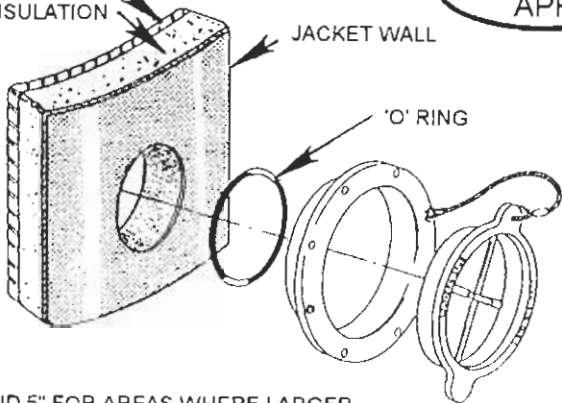

4" AND 5" FOR AREAS WHERE LARGER
UT INSPECTION IS REQUIRED.

CORRUGATED JACKET

NEOPRENE CORRUGATED TRANSITION
GASKET AVAILABLE FOR
2 1/2", 4" AND 5" FLANGES

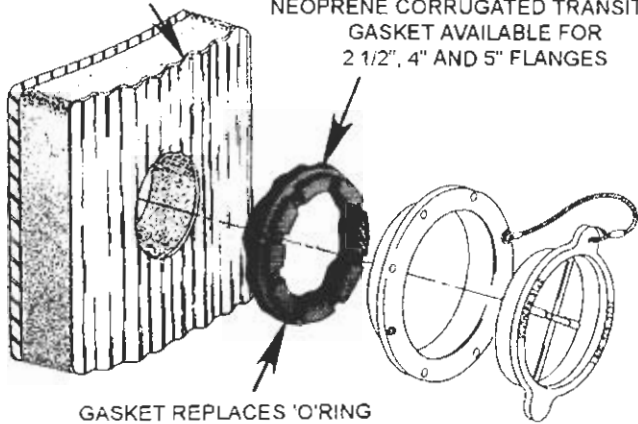

GASKET REPLACES 'O'RING

1/4" CORRUGATED GASKET ELIMINATES
HIGH LABOR COSTS OF INSTALLING A
CORRUGATED TRANSITION SHEET
AVAILABLE IN 2 1/2", 4" AND 5" SIZES.

2 1/2" FOR MAJORITY
OF LOCATIONS

2 1/2" APF

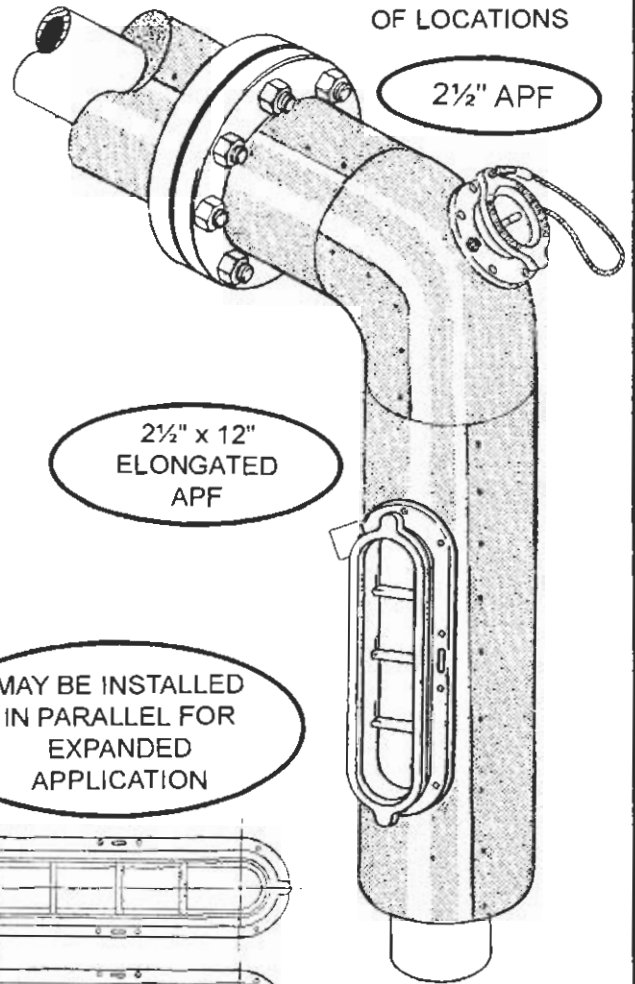

2 1/2" x 12"
ELONGATED
APF

MAY BE INSTALLED
IN PARALLEL FOR
EXPANDED
APPLICATION

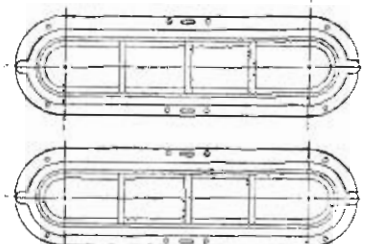

2 1/2" AND 2 1/2" x 12" AVAILABLE
WITH FIRE PROOF METAL COVER

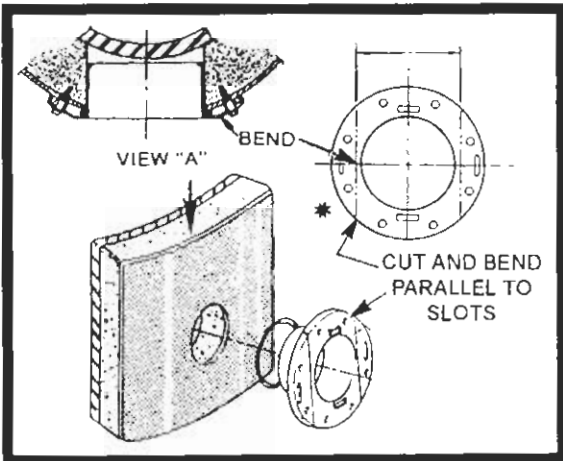

FIELD CUT OUTSIDE LIP BETWEEN
INJECTION PORTS AND BEND FLANGE AS
REQUIRED AS SHOWN FOR SMALL CONTOUR
CHANGES.



*2 1/2" FLANGE MAY BE
CONTOURED BY SNIPPING
FLANGE AS SHOWN

1 1/2" AND 1 3/4"
APF

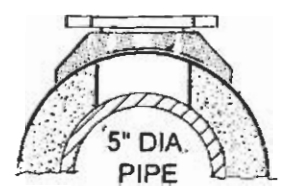

1 1/2" & 1 3/4" PRECONTOURED
FOR SMALL DIA. PIPE

ACCESS PLUG FLANGE INSTALLATION



LOCATE AND MARK
I.D. OF APF.



WITH A UTILITY KNIFE,
START CUTTING OUT
TRACED HOLE.



WITH TIN SNIPS CUT OUT
COMPLETE HOLE OR DRILL
WITH A 2 9/16" HOLE SAW.



CLEAN OUT INSULATION
AS REQUIRED.



FILL BACKSIDE OF FLANGE
WITH SILICONE



INSTALL 2 SELF STARTING
SCREWS ACROSS FROM
EACH OTHER, ONE FOR A
SAFETY LINE AND THE
OTHER FOR HOLDING AN I.D.
TAG

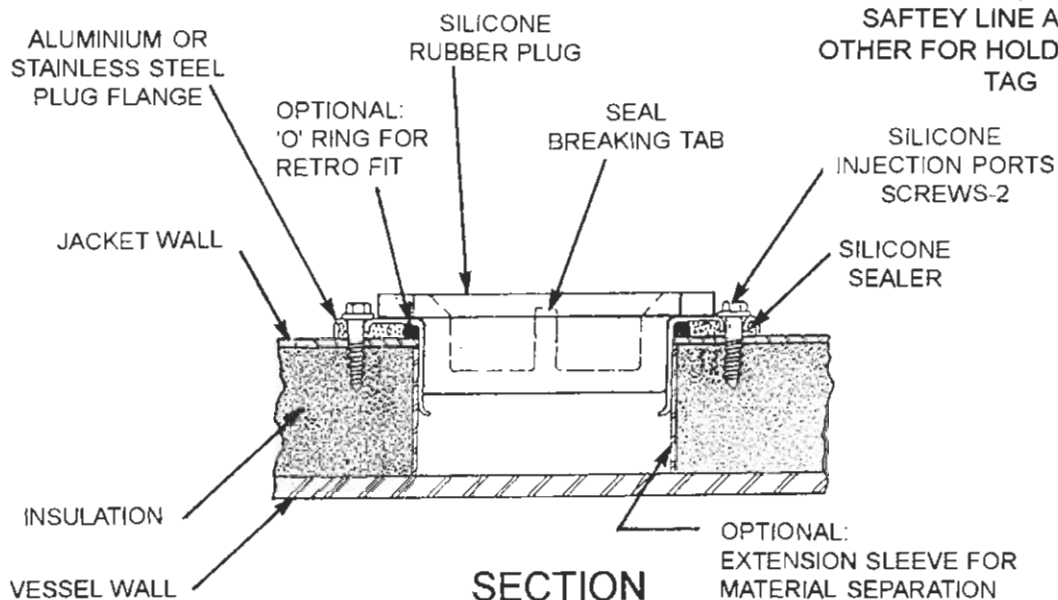

ACCESS PLUG FLANGES

FOR INSULATED PIPE (EPA INSPECTION PORTS)

* **HIGH TEMP METAL PLUG**
 * **WITH WEATHER TIGHT 'O' RING**

HT-1 - 600°F - 1000°F

SOUTHERN STUD WELD HAS DESIGNED AN ALL NEW HIGH TEMPERATURE METAL CAP WITH A MECHANICAL INNER SEAL AND A WEATHER TIGHT OUTER O-RING SEAL FOR HOT STEAM LINE APPLICATION.

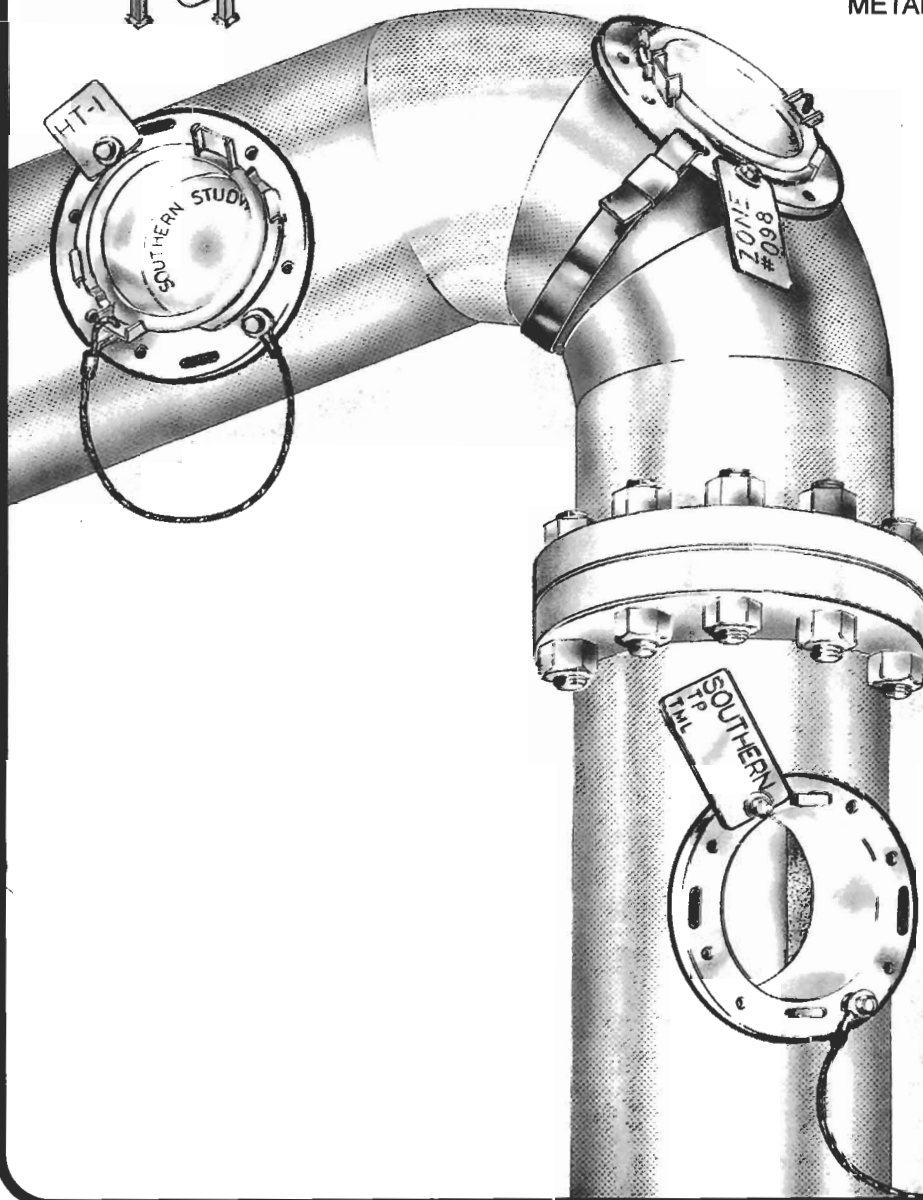
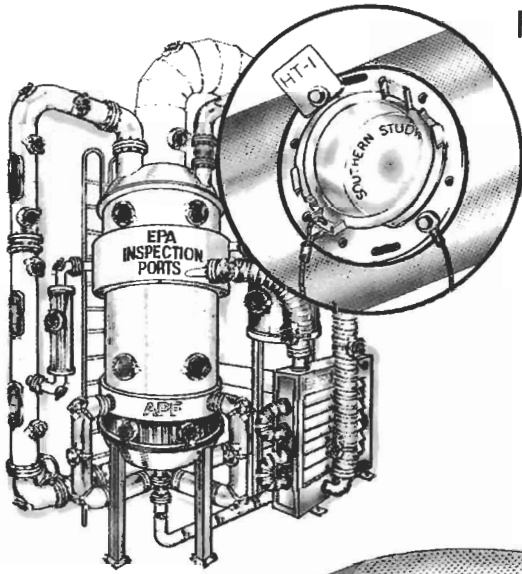

METAL TO METAL SEAL

'O' RING

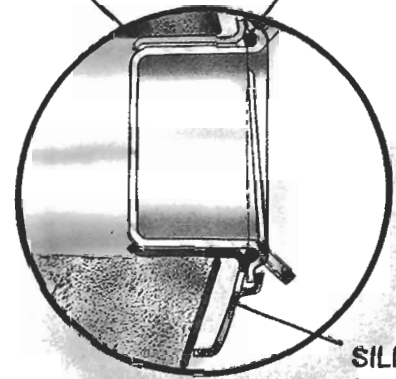

VIEW WITH PLUG IN PLACE

SILICONE PRIMARY HOLDING AGENT

TWO SEALS:

- INNER - RADIANT BARRIER MECHANICAL METAL SEAL
- OUTER - 'O' RING WEATHER SEAL

ACCESS PLUG FLANGES

FOR INSULATED PIPE (EPA INSPECTION PORTS)

**HIGH TEMP WEATHER TIGHT
METAL PLUG WITH 'O' RING
AND HIGH TEMP INSULATION PAD
HT-2 - 600°F - 1200°F**

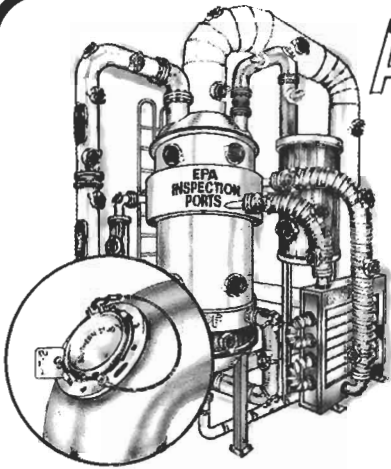

INTRODUCING THE FIRST AND ONLY ACCESS PLUG FLANGES FOR EXTENDED HOT APPLICATIONS DESIGNED WITH HIGH TEMP INSULATION PAD FOR RETAINING INSULATED INTEGRITY AND PREVENTING INSULATION LOSS.

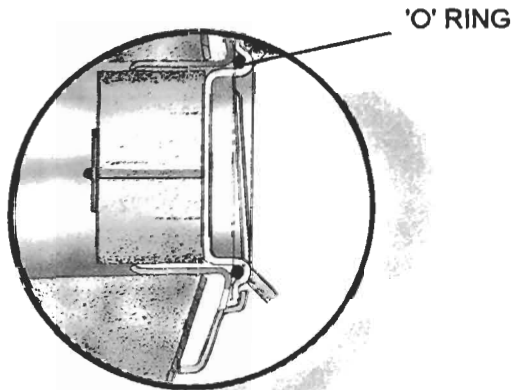

**'O' RING WEATHER SEAL
WITH RETAINED INSULATION
PAD TO PREVENT B.T.U. &
INSULATION LOSS**

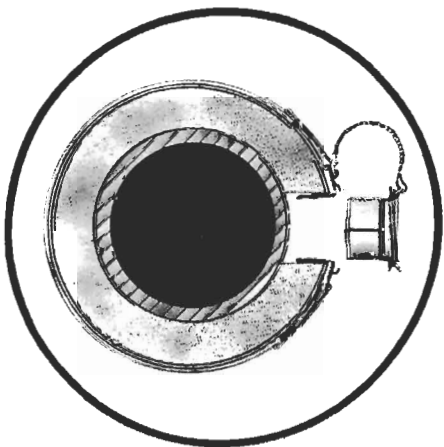

BANDING STRAP OPTION

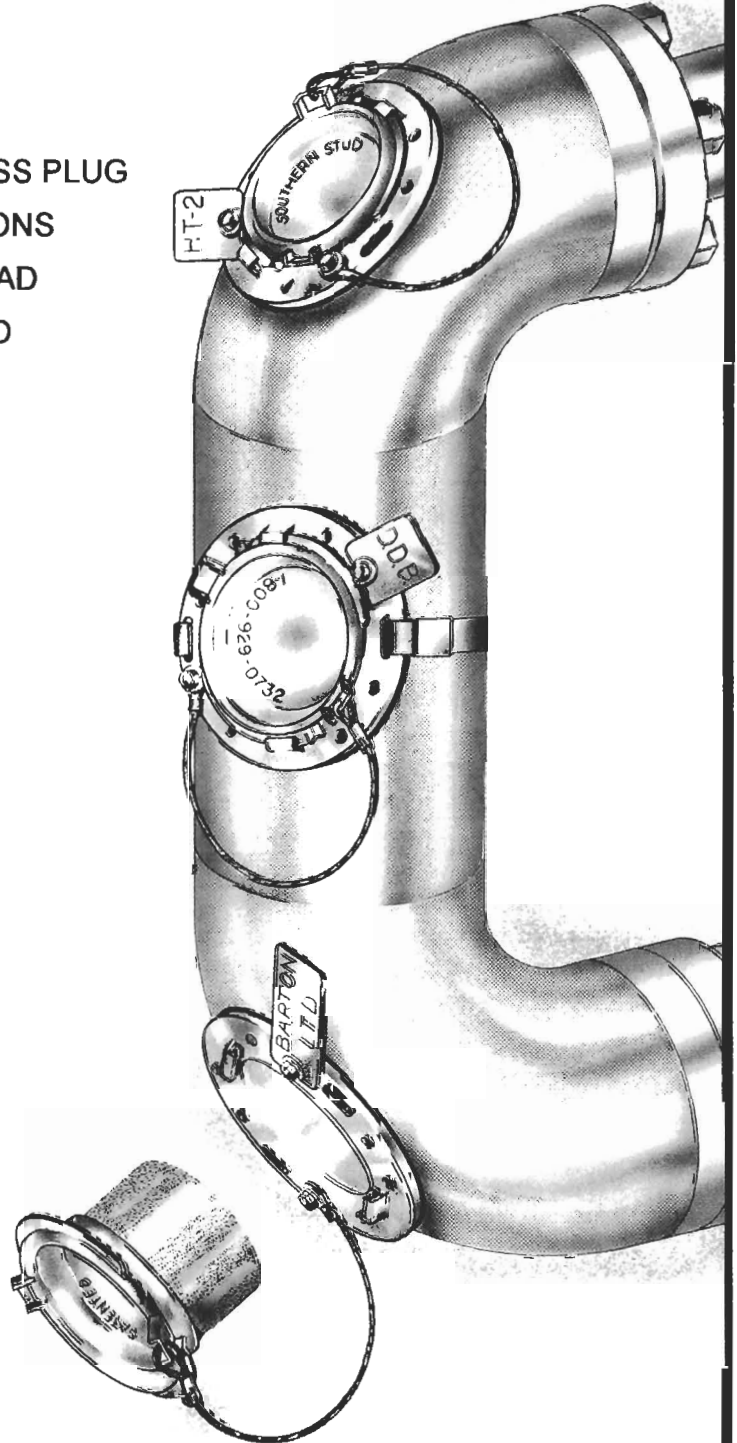

SIZES AND STYLES AVAILABLE

SILICONE RUBBER PLUG:

SILVER - 600°F

RED - 500°F

BLUE - 350°F

GREEN FOR COLOR CODING

*TRANSITION GASKET AVAILABLE FOR 2 1/2", 4" AND 5"

B/L = BENDLINE

1 1/2" INSPECTION PORT

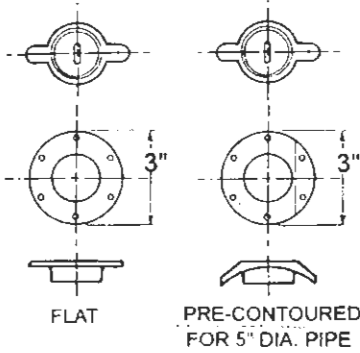

1 1/4" INSPECTION PORT

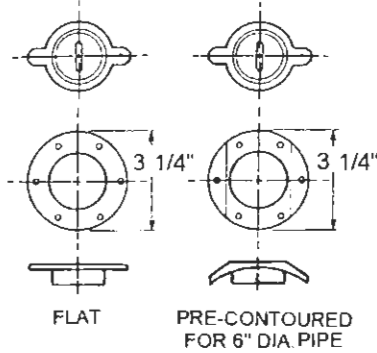

2 1/2" INSPECTION PORT*

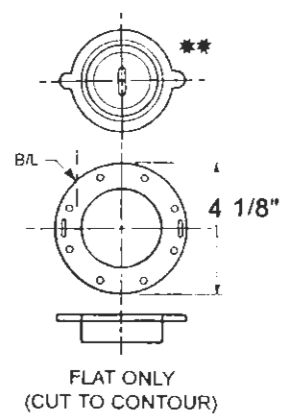

4" INSPECTION PORT*

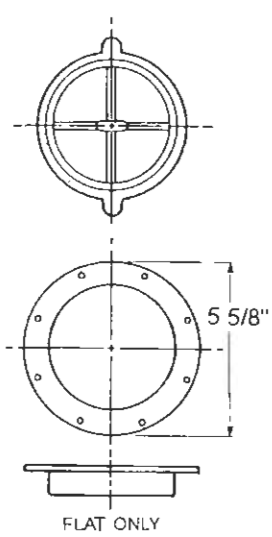

5" INSPECTION PORT*

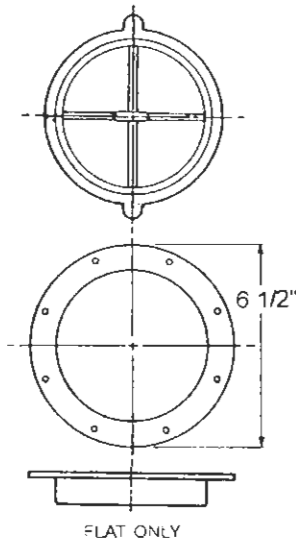

2 1/2" X 12" ELONGATED FLANGE INSPECTION PORT **

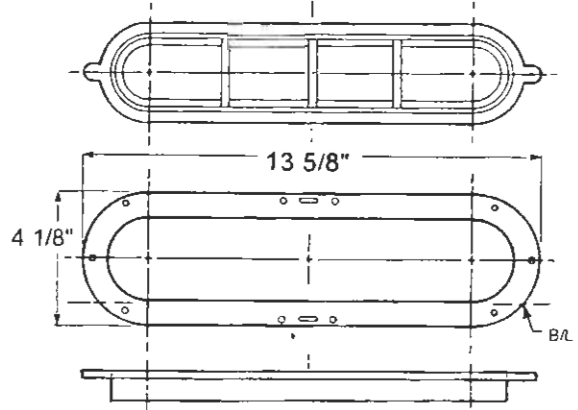

**2 1/2" AND 2 1/2" x 12" AVAILABLE WITH FIRE PROOF METAL COVER

HT-1 2 1/2" ONLY 600°F - 1000°F INSPECTION PORT

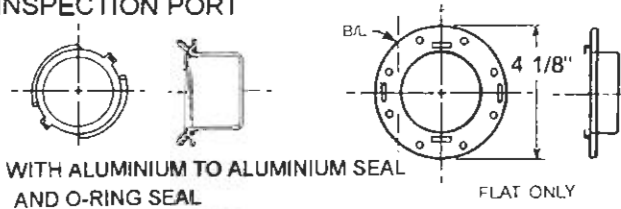

HT-2 2 1/2" ONLY 600°F - 1200°F INSPECTION PORT

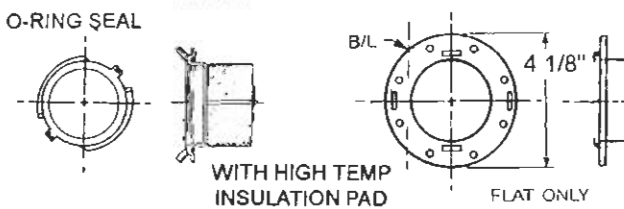

COLD CHECK INSPECTION PORT TO -185°F

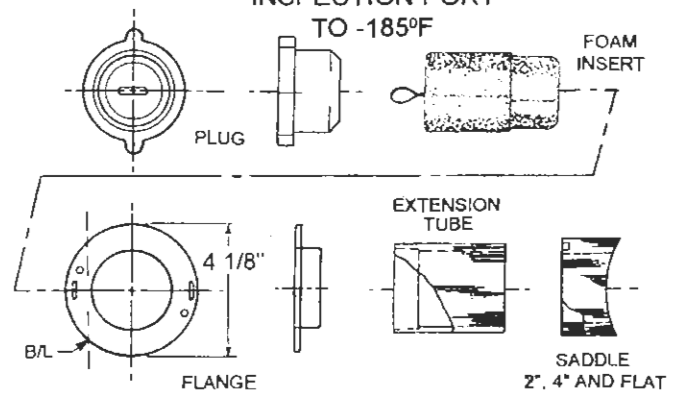

EFFECTS OF TEMPERATURE ON HARDNESS/FLEXIBILITY 30 DAY TESTS

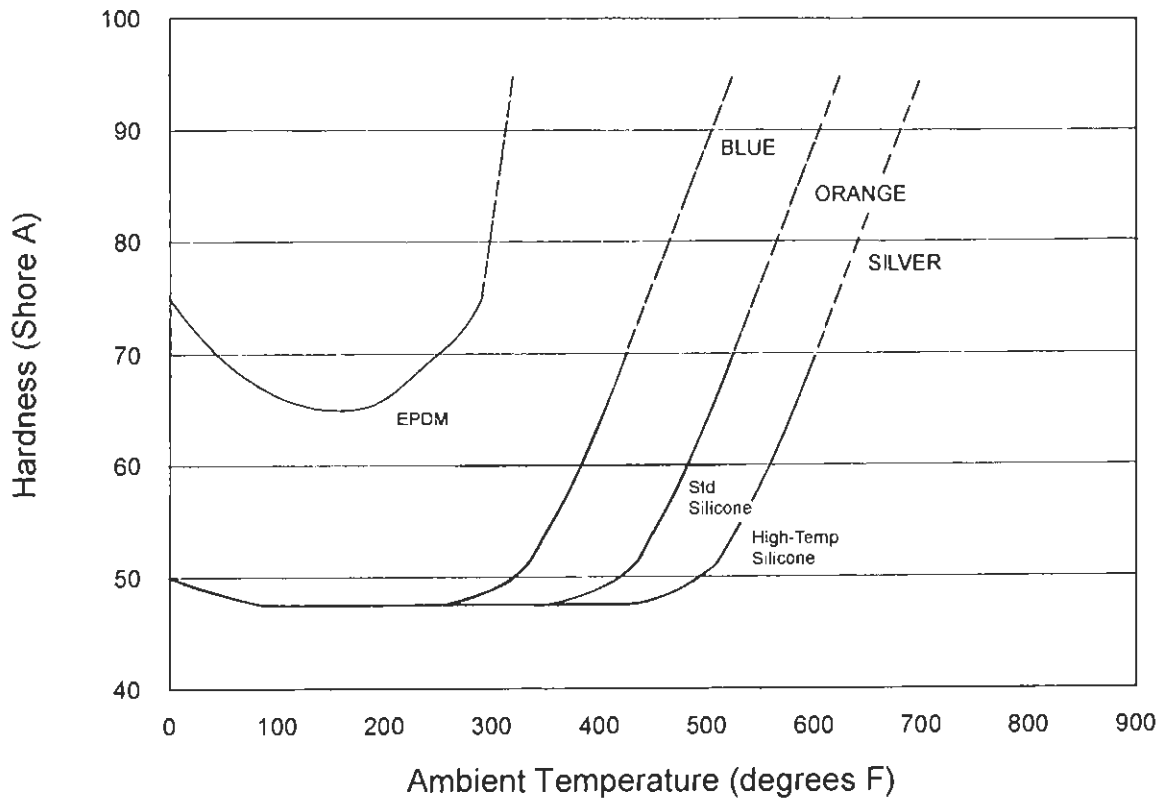

EFFECTS OF TEMPERATURE ON COMPRESSION SET (ABILITY TO RETAIN MOLDED DIMENSIONS)

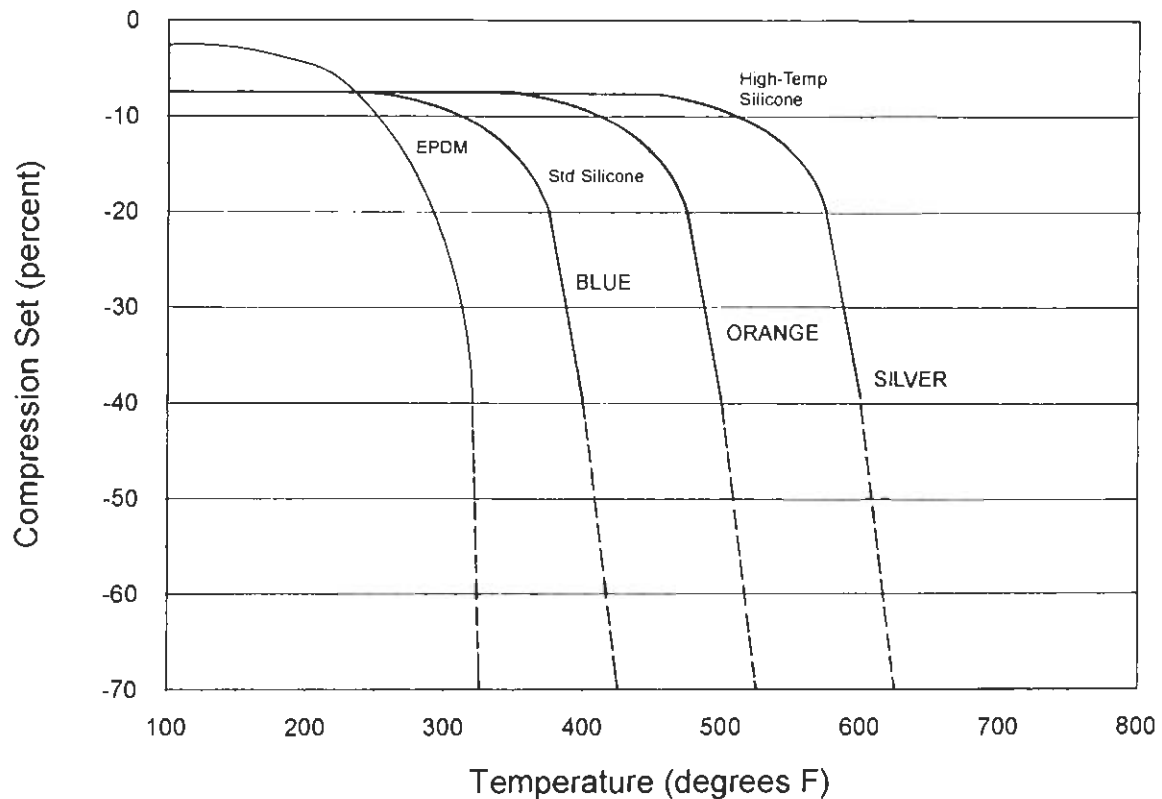

ACCESS PLUG FLANGES

FOR INSULATED PIPE (EPA INSPECTION PORTS)



**COLD CHECK
TO -185°F**

SOUTHERN STUD WELD INTRODUCES THE FIRST AND ONLY ACCESS PLUG FLANGE FOR ON LINE CRYOGENIC APPLICATIONS DESIGNED WITH AN EXTENSION SLEEVE, A SILICONE SADDLE GASKET AND A FOAM INSERT TO PRESERVE THE INTEGRITY OF THE VAPOR BARRIER WHICH WILL PREVENT ICE BUILD-UP.

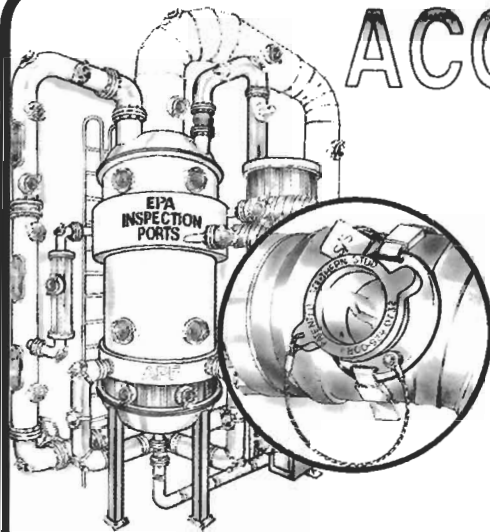

NOTE: TO HELP WITH ICE BUILD-UP DURING TESTING, SPRAY NON-TOXIC PROPYLENE GLYCOL ANTIFREEZE, 50 / 50 MIX = -70°F. NOT A HAZARDOUS CHEMICAL

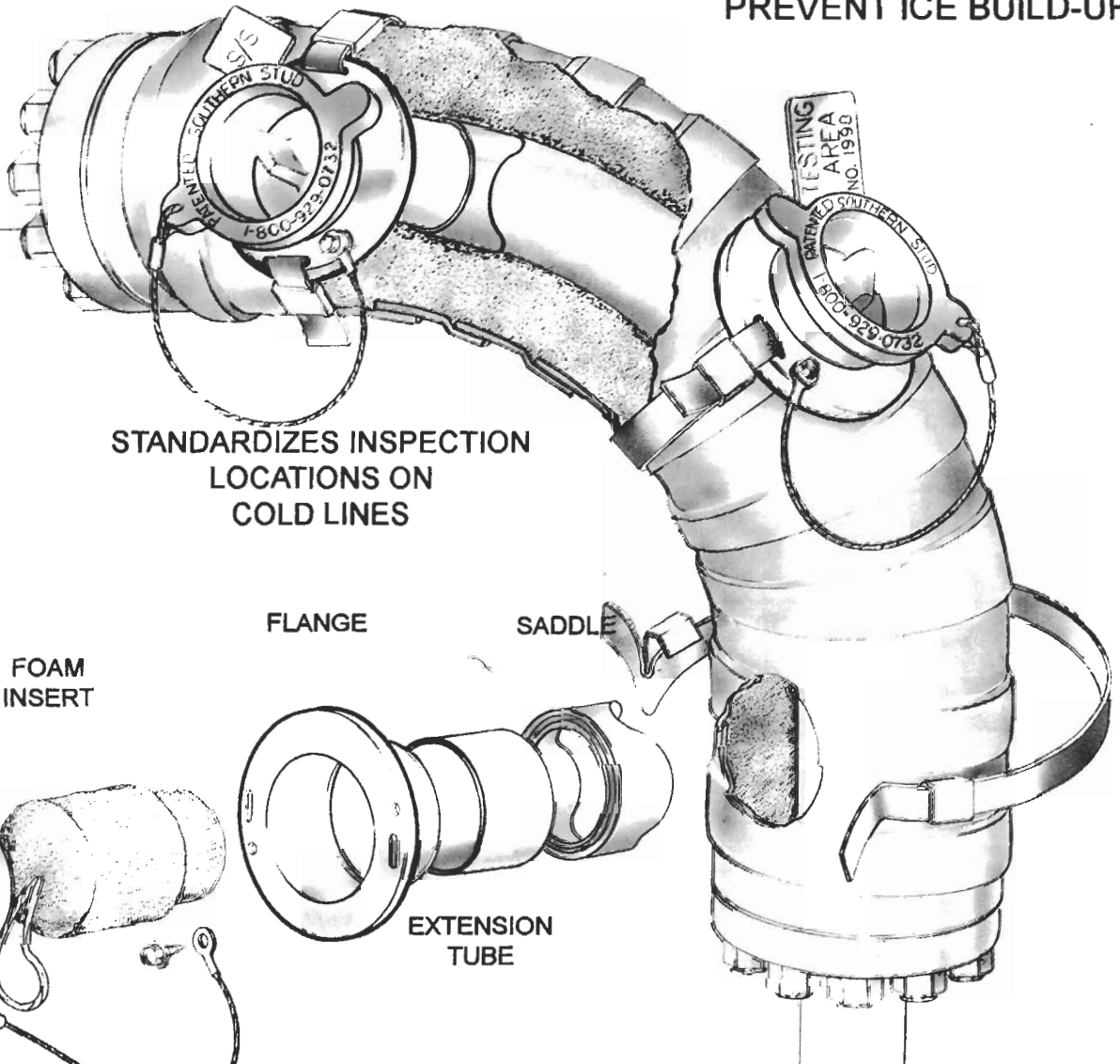

STANDARDIZES INSPECTION
LOCATIONS ON
COLD LINES

FOAM
INSERT

FLANGE

SADDLE

EXTENSION
TUBE

INSTALLATION

FOR MOST APPLICATIONS, INSULATION TUBE WILL COME PRE-CUT TO PROPER LENGTH.

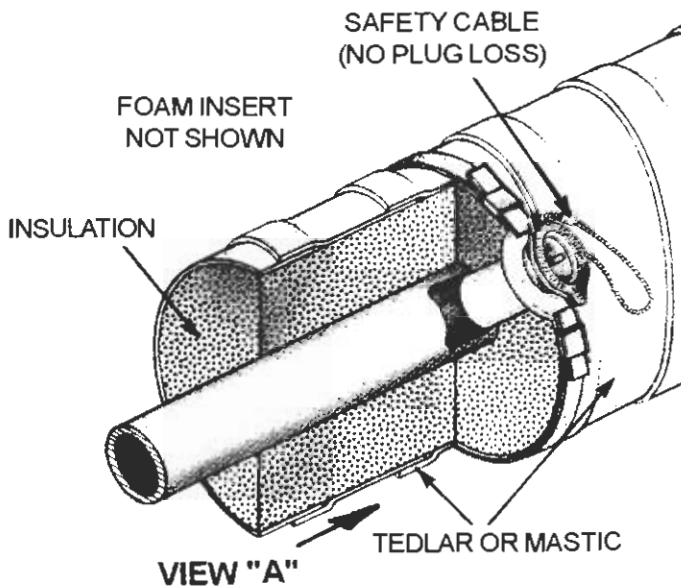

①

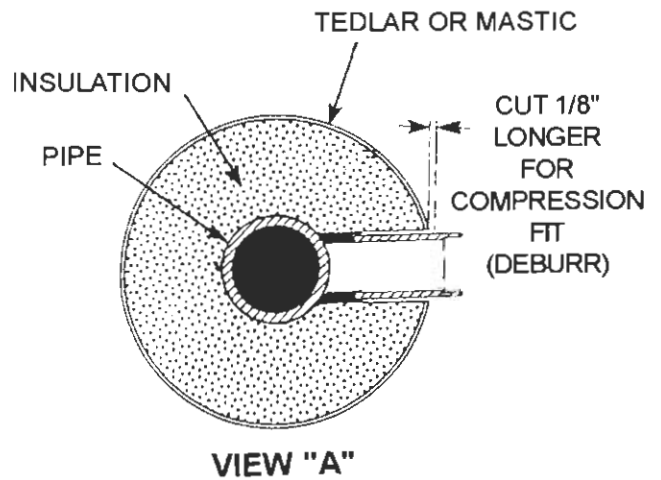

FOR FIELD CUT, INSTALL INSULATION TUBE INTO SILICONE SADDLE GASKET, PUT IN PLACE AS SHOWN AND MARK. REMOVE FROM PIPE, CUT OPPOSITE END TO PROPER LENGTH. (DO NOT CUT MACHINED END OF TUBE) DEBURR.

②

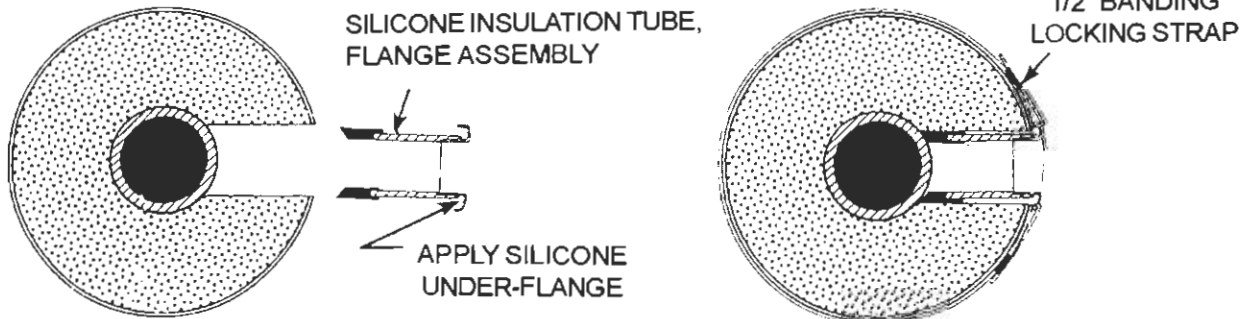

APPLY SILICONE UNDER FLANGE AND INSERT ASSEMBLY INTO POSITION. SECURE IN PLACE WITH 1/2" BANDING LOCKING STRAP.

③

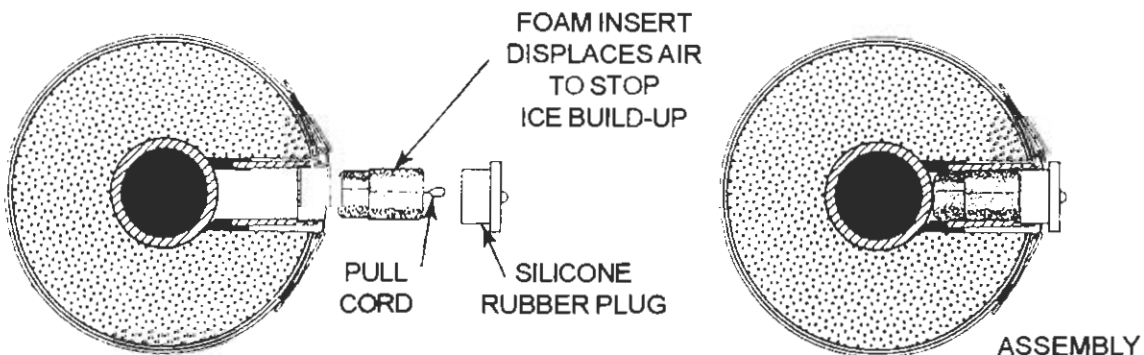

PUT FOAM INSERT IN PLACE AND INSTALL RUBBER PLUG

CHECK POINT

STICKER PROTECTION COVER

FOR NON-INSULATED PIPE
(FOR EPA INSPECTIONS)

- INCREASES STICKER LIFE

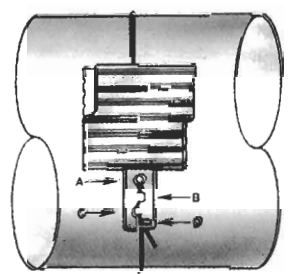
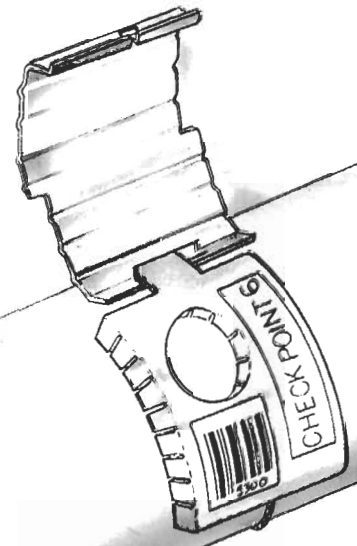
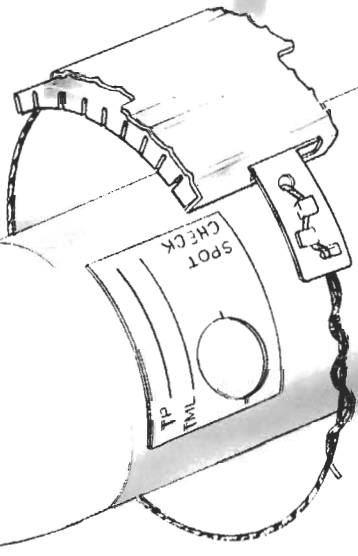
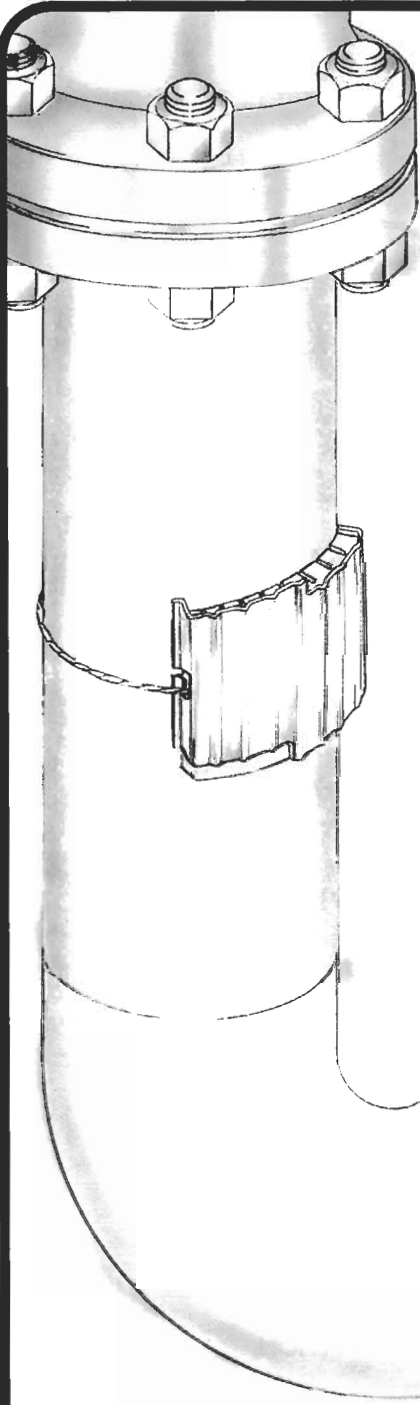
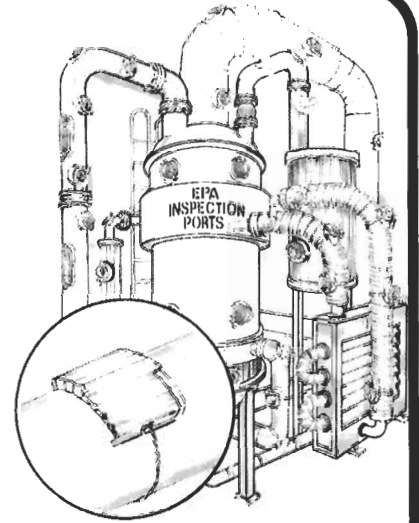

- TO PROTECT LOCATION OF TEST SPOT FROM SAND BLASTING, PAINTING CREW AND DIRTY AREAS.

LOOP CABLE AROUND PIPE THROUGH HOLE A, PULL TIGHT TILL SPRING HAS TENSION. PULL CABLE DOWN INTO SLOT B, THEN BACK INTO SLOT C AND BACK THRU TAB SLOT.

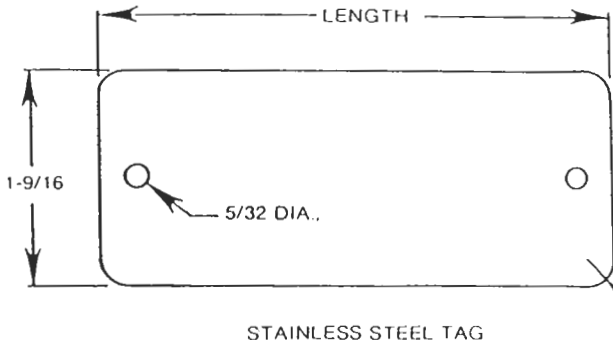

STAINLESS STEEL TAG
.015 THICK

NAME TAGS FOR:
EQUIPMENT IDENTIFICATION,
LOCATIONS, AREAS, DATES,
COMPANY ADDRESS, SERIAL NUMBERS,
INSPECTIONS, ETC.

LENGTH
STANDARD 1-9/16
AS REQ.D

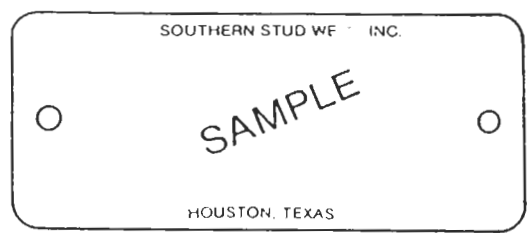

INSPECTION POINT LABELS



COLOR
RED
WHITE LETTERS

UT1010TG

FOR STICKERS
THAT REQUIRE
INFORMATION

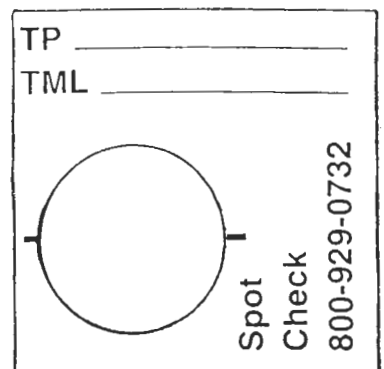

COLOR
SILVER
BLACK LETTERS

UT1025TG

Product Specifications

- Backing is 3.5 mil of 3M # 200 "High Performance " Acrylic for strong bonding on textured surfaces.
- Leachable chloride, fluoride and sulfur in the adhesive, as measured by ion chromatograph - PPM - is 3, less than one, and less than one, respectively.
- Will withstand temperature range from -40°F to +300°F Minimum application temperature is 58°F.
- Resistance to chemicals such as isopropyl alcohol, detergents, engine oils and waters.
- Over laminate is 3.5 mil of matte silver Mylar polyester material. Matte coating resists degradation from scuffing, chemicals, moisture and wide temperature fluctuations.

ASK FOR SPECIFICATION SHEET

MANY SIZES AND STYLES AVAILABLE
FOR ALL YOUR PLANT APPLICATIONS

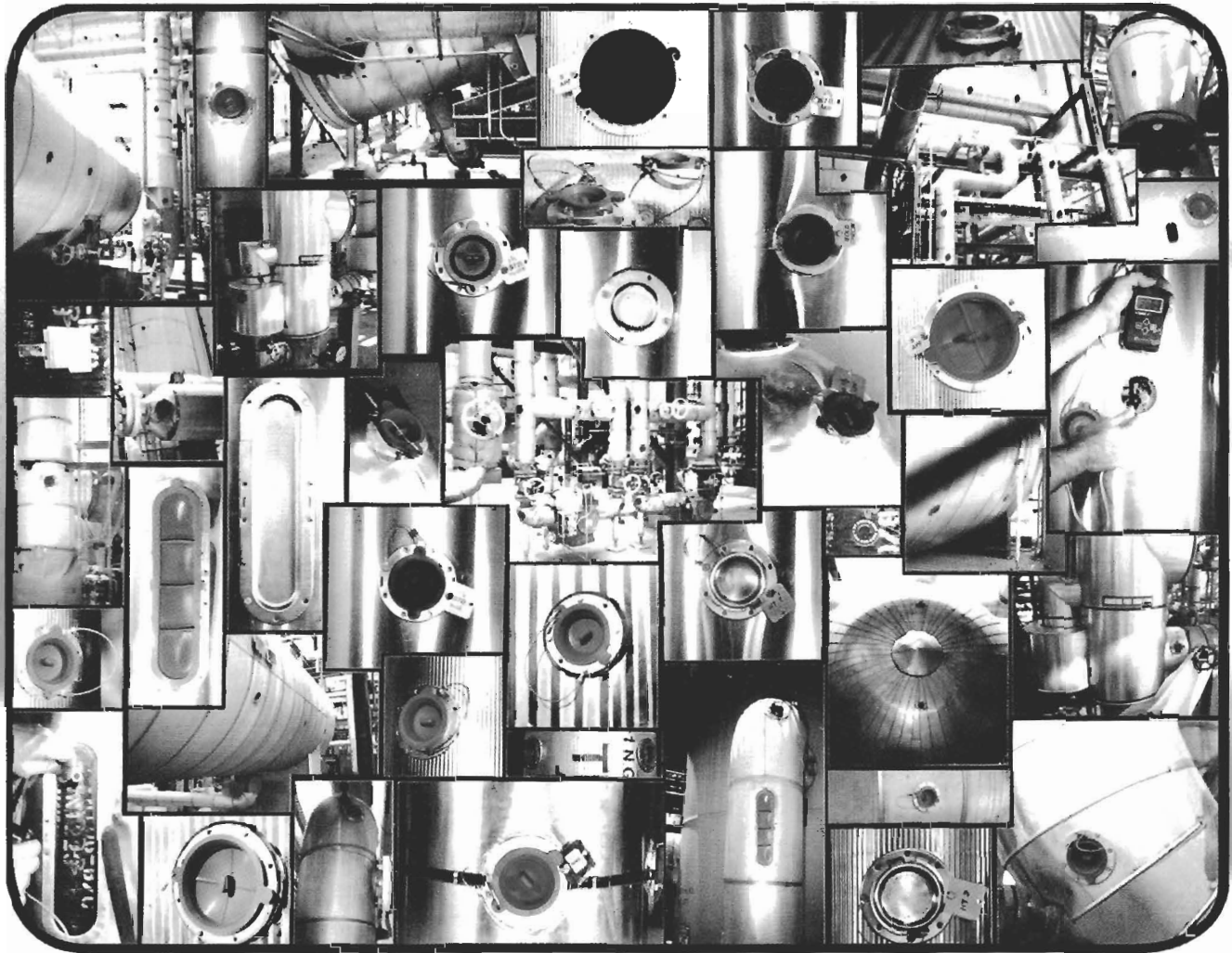

MAKING THINGS WORK

Southern Stud Weld, Inc., dba Barton Resources

HOUSTON, TX 1-800-929-0296

DALLAS, FORT WORTH, TX 1-800-929-0732

3910 H NORTH FRWY., HOUSTON, TX 77022

(713) 691-0897 FAX (713) 691-3699

3645 CONFLANS, IRVING, TX 77061

(972) 790-3339 FAX (972) 313-0864

E-MAIL: ssw@studweld.com

VISIT OUR WEBSITE @ [HTTP://INSPECTIONPLUG.COM](http://inspectionplug.com)

Designed by: TechArt Design Services, Houston, Texas (713) 461-3387